

CRLS

Cambridge Rindge & Latin School



VISITOR'S MAP

CRLS CONTACTS

All extensions can be dialed directly when preceded by (617) 349-[extension].

Main Office	459 Broadway, Cambridge, MA 02138	(617) 349-6630
Christopher Saheed	Principal	x6632
Robert Tynes	Assistant Principal	x6707
Michael Ananis	Rindge School of Technical Arts Executive Director	x6766
Joseph Dolan	High School Extension Program Principal	x6681
John Silva	Director of Security	x6772
Greta Hardina	Parent Liaison	x6660
Chris DeYeso	Special Education/TIC	x6734
Lynn Williams	Coordinator of Guidance/Career & College Resource Center	x6697
Leslie Davis	AVID CRLS Site Coordinator	x6763
Adolescent Parenting Program		x6740
Career & College Resource Center		x6697
CRLS Library		x6781
Court Liaison		x6737
International Student & Family Center		x6785
MCAS Coordinator		x6796
Scholarship Coordinator		x7760
School Nurse/Teen Health Center		x6719 (617) 498-1548
School Fax		(617) 349-6749

Learning Community "C" (617) 349-6674

Linda Mason	Dean of Curriculum & Program	x6676
Debbie Gentile	Secretary	x6674
Susie M. Espinosa	Dean of Students	x6681
Jean Kuropatkin	Secretary	x6680
George Finn	Guidance Counselor	x6671
Stephanie Richards	Guidance Counselor	x6642
Katherine Rocco, LICSW	Clinical Social Worker	x6874

Learning Community "R" (617) 349-6661

Damon Smith	Dean of Curriculum & Program	x6662
Martha Sennott	Secretary	x6661
Maria DiClemente	Dean of Students	x6738
Patricia Williams	Secretary	x6736
Lorraine Suarez Davis	Guidance Counselor	x6684
Michael Tubinis	Guidance Counselor	x6757
Mara Bentman	Clinical Social Worker	x4474

Learning Community "L" (617) 349-6638

Allan Gehant	Dean of Curriculum & Program	x6637
Anna Sullivan	Secretary	x6638
Filomena Silva	Dean of Students	x6664
Miriam DaSilva	Secretary	x6663
Janani Nathan	Guidance Counselor	x6641
Larry Poirier	Guidance Counselor	x6666
Allison Wade, LICSW	Clinical Social Worker	x6751

Learning Community "S" (617) 349-6652

Kathy Wamness	Dean of Curriculum & Program	x6652
Carol Correia	Secretary	x6652
Jamalh Prince	Dean of Students	x6723
Donna DiTucci	Secretary	x6704
Dan Weathersby	Guidance Counselor	x6758
Jodi Mace	Guidance Counselor	x6655
Janeen Bono	Clinical Social Worker	x4124

CRLS Curriculum Department Contacts

Kathy Wamness	MATH	x6652
Allan Gehant	SCIENCE	x6637
Damon Smith	HISTORY/SOCIAL SCIENCE	x6662
Linda Mason	ENGLISH LANGUAGE ARTS	x6676
Elaine Koury	VISUAL & PERFORMING ARTS	x6789
Kim DeAndrade	HEALTH & PHYSICAL EDUCATION	x3374
Sal Trapani	WORLD LANGUAGES	x6718



CONSTRUCTION/RENOVATION AREA



2ND FLOOR

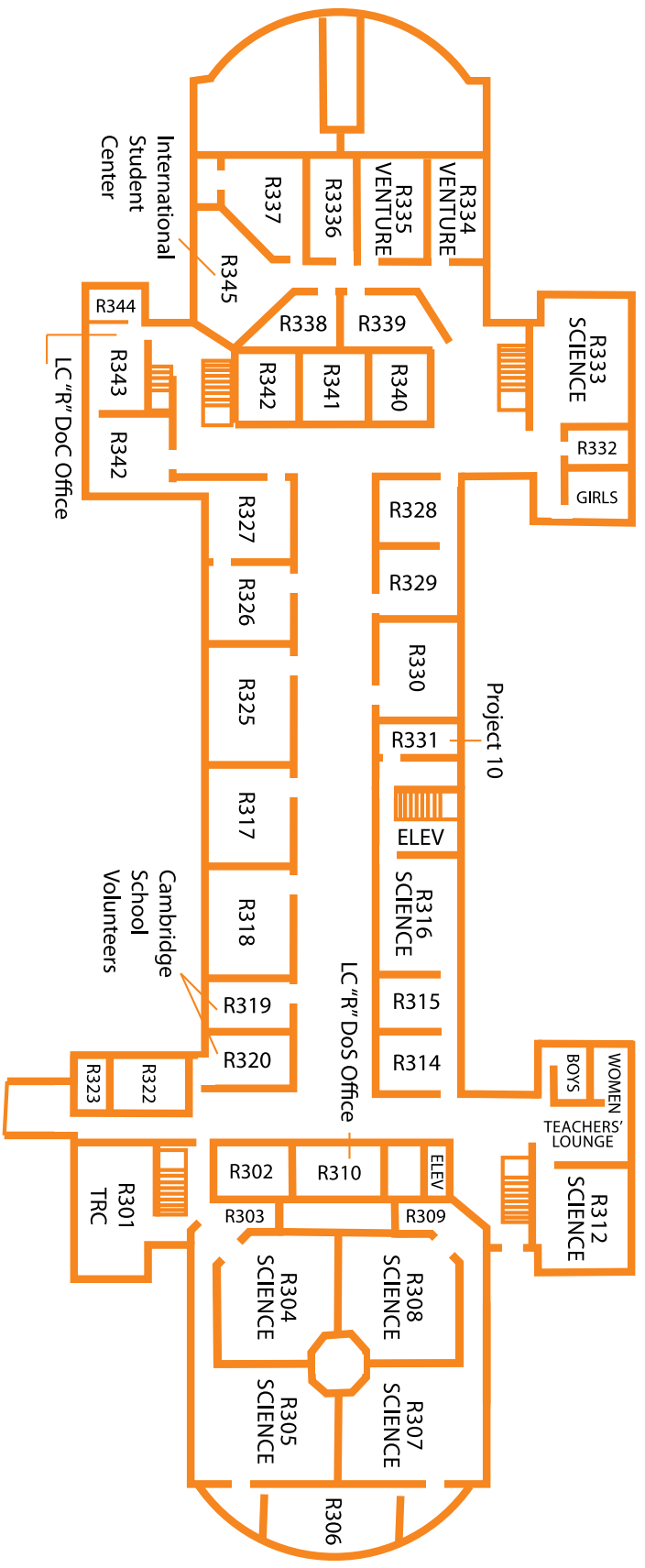

3RD FLOOR

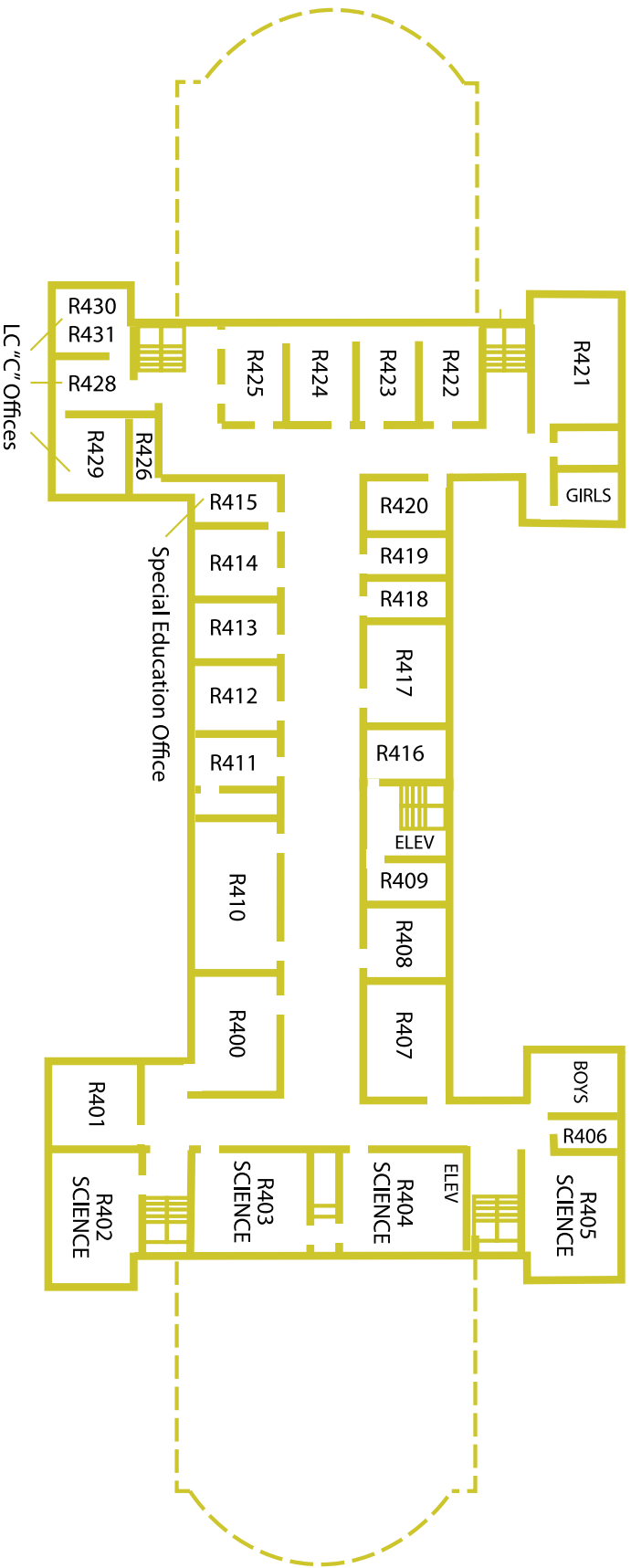

4TH FLOOR

5TH FLOOR

